

Draft Section 1:50

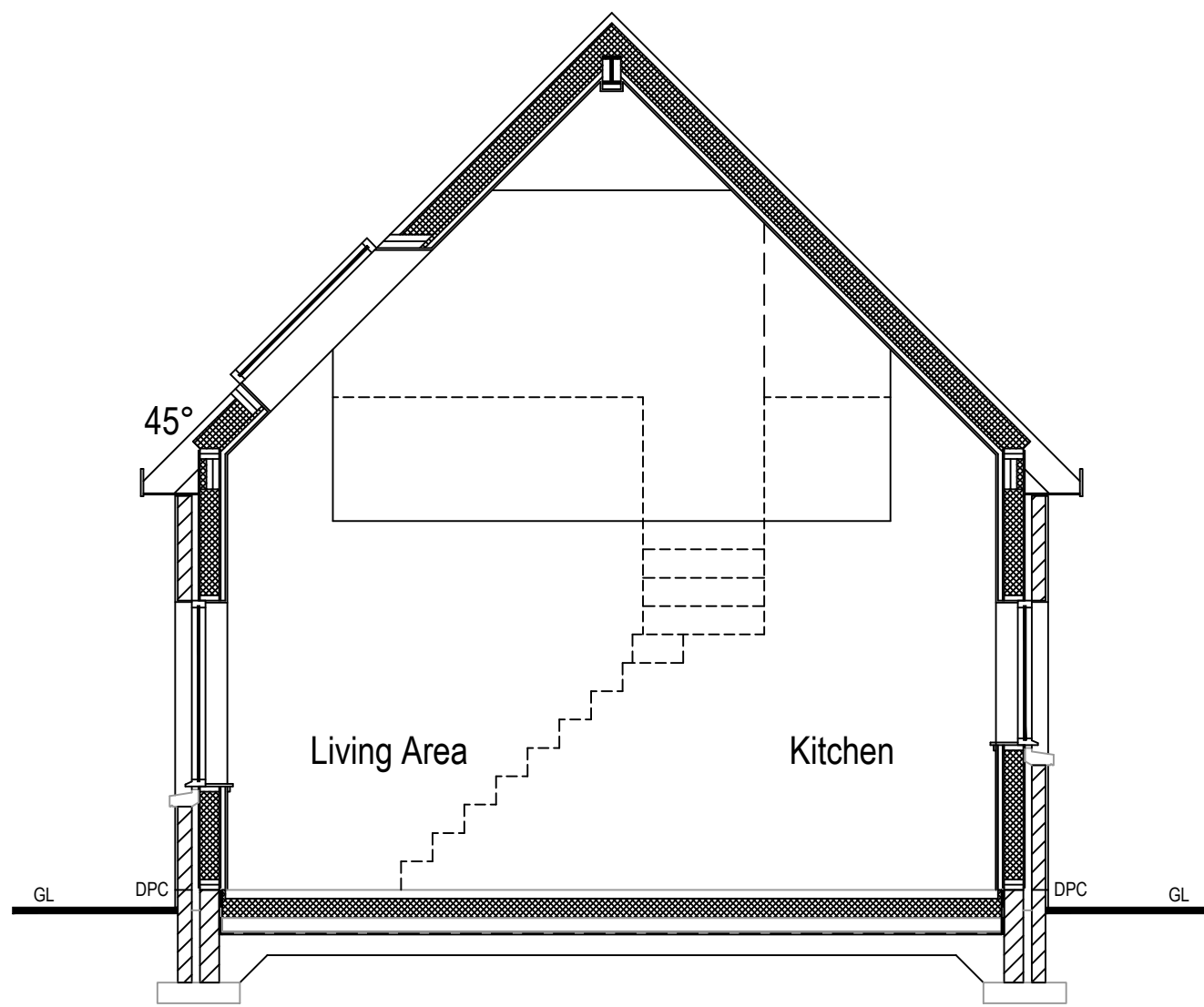

Draft Section 1:50

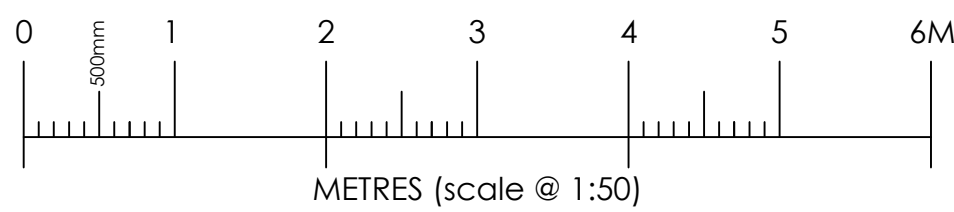
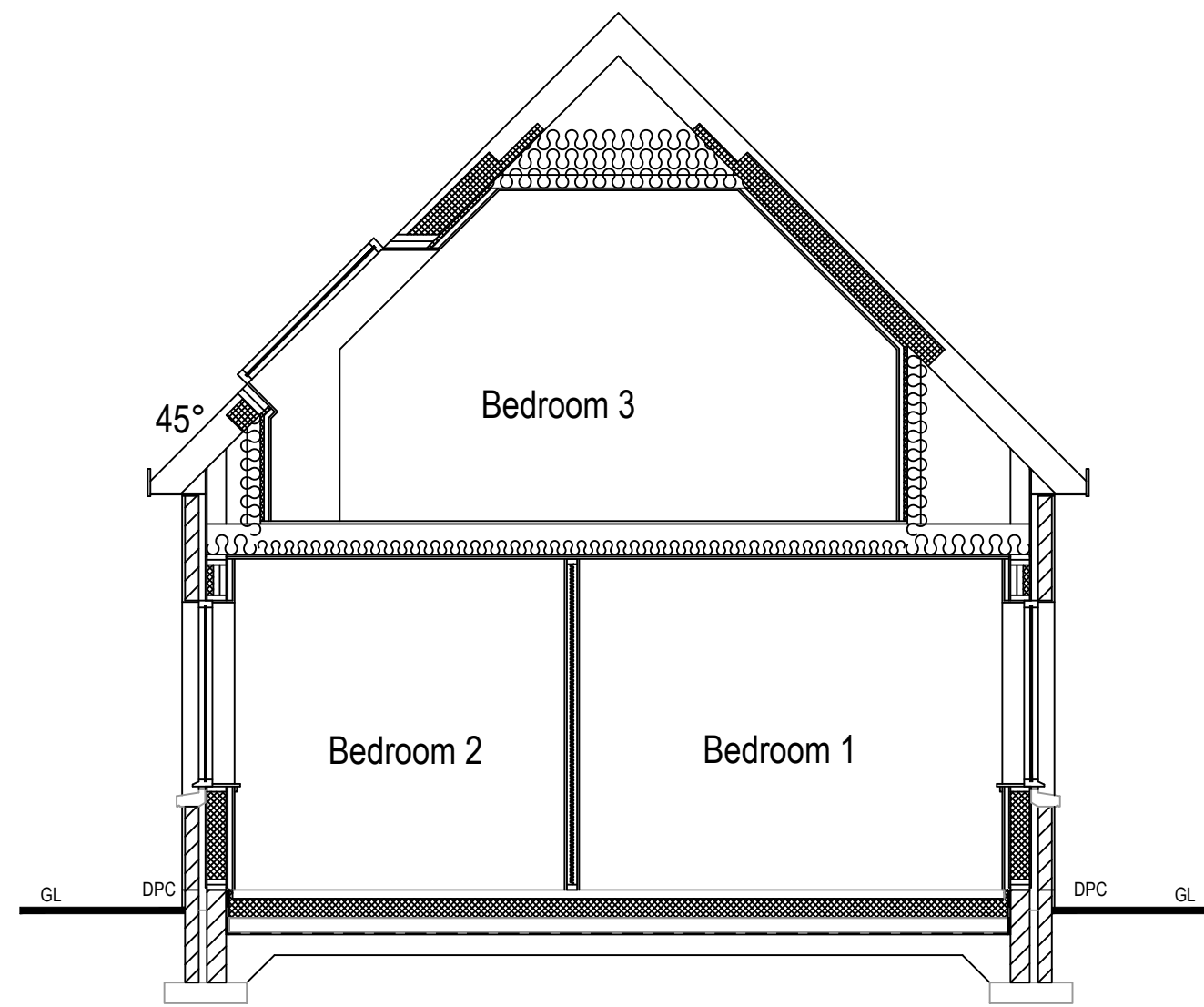
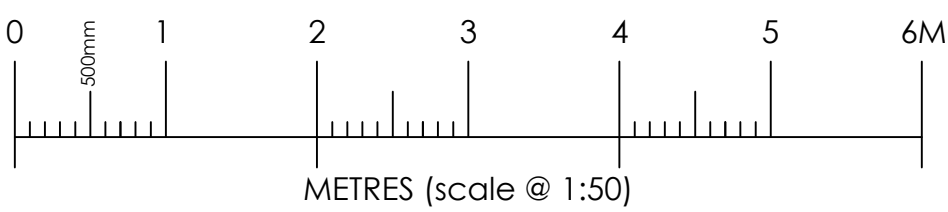

Draft Section 1:50

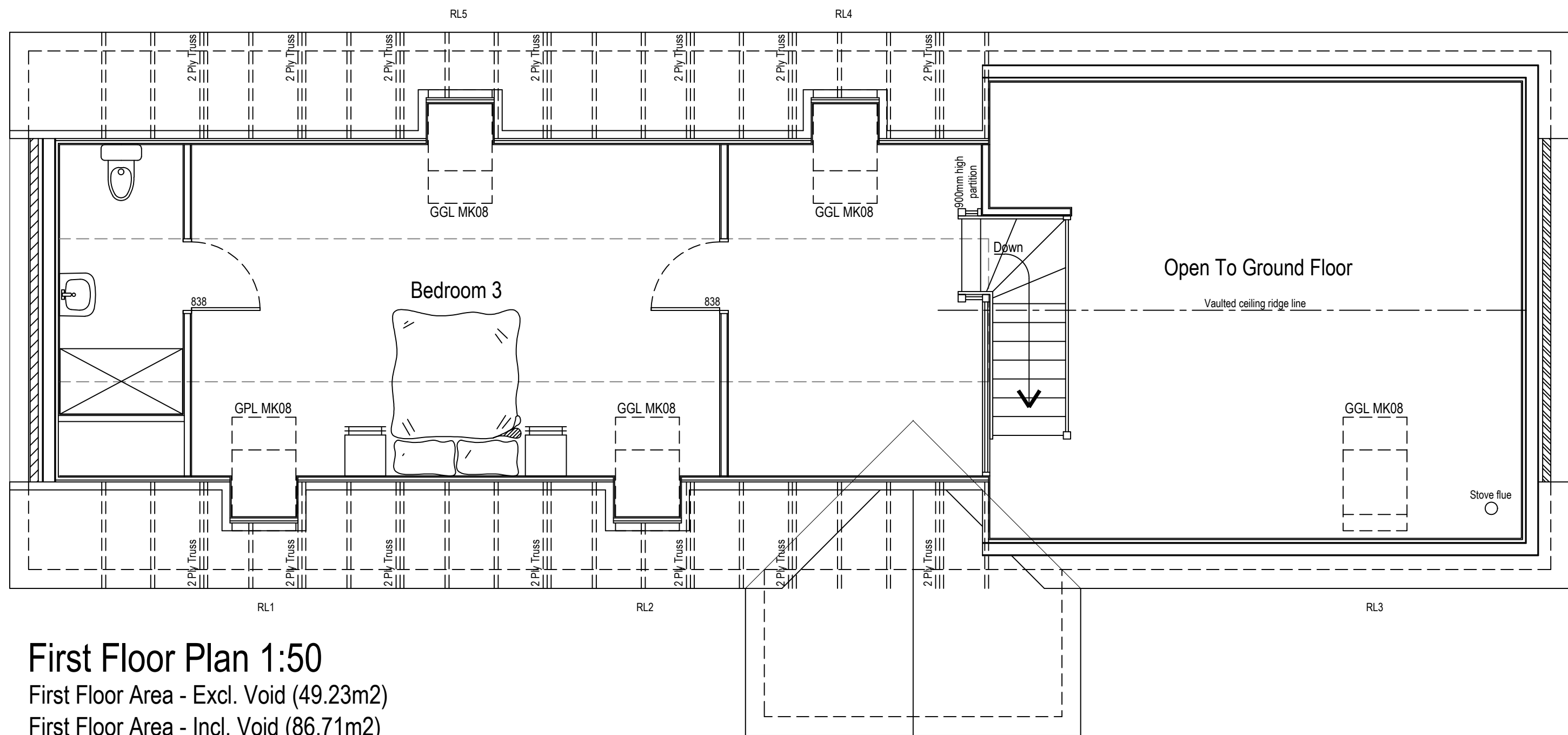
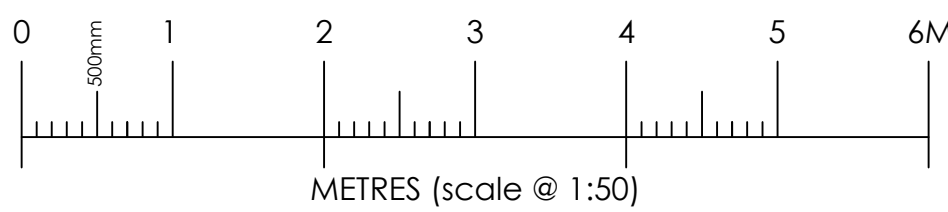

First Floor Plan 1:50

First Floor Area - Excl. Void (49.23m2)

First Floor Area - Incl. Void (86.71m2)



These plans must be read in conjunction with the local authority approval documents and the associated conditions.

It is the sole responsibility of the Client/Main Contractor to provide and implement any appropriate safety plan required under current CDM (Construction Design and Management) Regulations.

Main Contractor/Client shall ensure all works are carried out in accordance with current building regulations/technical standards and any associated NHBC, Project Engineers, Project Supervising Architects, BS, and BRE requirements etc. Main Contractor/Client to ensure all utility companies are consulted prior to works commencing on site. All sizes to be checked on site.

COPYRIGHT:-  
THIS DRAWING IS COPYRIGHT & CANNOT BE COPIED IN WHOLE OR IN PART  
WITHOUT THE WRITTEN CONSENT OF SCOTFRAME TIMBER ENGINEERING LIMITED.

Rev	B	FURTHER CLIENTS ALTS ADDED	GM	09.2022
Rev	A	CLIENTS ALTS ADDED	GM	09.2022
Rev				Date

Client:  
Mr & Mrs Payne  
(First Floor Plan & Draft Sections)

Site:  
Proposed House At Land East of Crosston,  
Aberlemno,  
Forfar, DD8 3PE

**Scotframe**

Scotframe Timber Engineering Ltd, Inverurie Business Park,  
Souterford Avenue, Inverurie, Aberdeenshire, AB51 0ZJ  
e-mail: inverurie@scotframe.co.uk  
Also At:-  
4 Grayhill Road, Westfield, Cumbernauld G68 9HQ  
e-mail: cumbernauld@scotframe.co.uk

scales:	drawn:	date:	Dwg No:	rev:
1:50 @ A1	G. Mathieson	09.2022	SF32116-002	B